

LEG MAINTENANCE SPARE PARTS AT PAGE 2:
MANFROTTO SERVICE CENTER PROVIDE
PROFESSIONAL MAINTENANCE ON THE LEG.
PLEASE REFER TO THEM

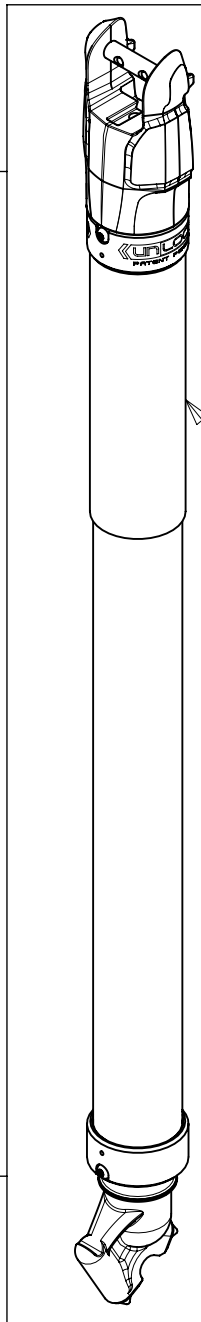

[FAST HANDLE]
R114865
set of 3

ASSEMBLED LEG
WITHOUT LABEL
RE114860
-
ASSEMBLED LEG
WITH LABEL
RE114860L

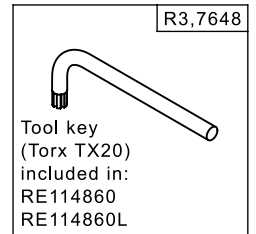

Tool key
(Torx TX20)
included in:
RE114860
RE114860L



Tool key
(Hexagonal 2mm)
included in:
RE114810

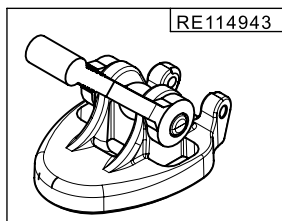
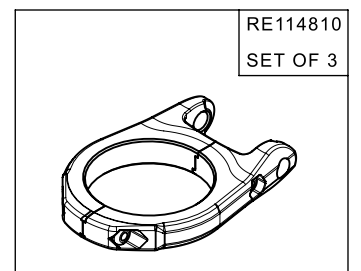

STRAP/HANDLE
R114867

BOX for MVTSNGFCUS
RI,500,18,16 SET OF 4

BOX for MVTSNGFC
RI,500,18,15 SET OF 4



Manfrotto
Imagine More

ART. MVTSNGFC
MVTSNGFCUS

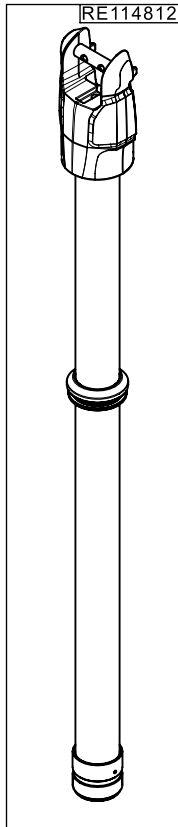

RE114812



R114858

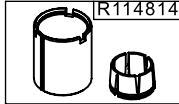

R114814



RE114815
includes D114814

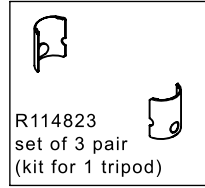

R114823
set of 3 pair
(kit for 1 tripod)

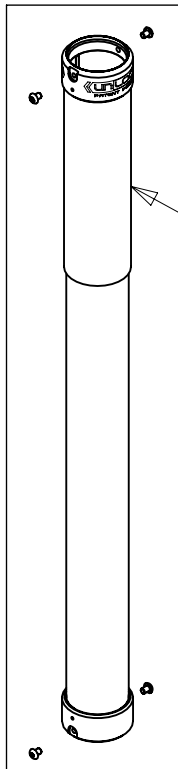

[FAST HANDLE]
R114865
set of 3

FAST TUBE
WITHOUT LABEL
RE114801
-
FAST TUBE
WITH LABEL
RE114801L

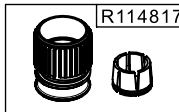

R114817



RE114818
includes D114817

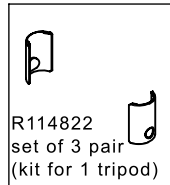

R114822
set of 3 pair
(kit for 1 tripod)



R3,7648

Needed for any
maintenance
activity on the leg

FOR ANY MAINTENANCE ON THE LEG
IS HIGHLY RECOMMENDED TO REFER TO A
MANFROTTO SERVICE CENTER